



Quality Access Doors- **FAST!**

## APPLICATION

This fire-rated door can be used wherever it is necessary to provide service access to shafts and any other location which must have a fire rating. Approved ceiling use.

## OPTIONS (AT ADDITIONAL COST)

### FINISHES:

- Stainless Steel Type 304 No. 4 Satin Finish Brushed
- Stainless Steel Type 316 No. 4 Satin Finish Brushed

### OPTIONS:

- Mortise lock and locks by others
- Hot Smoke Seal\* gasket all 4 sides
- Special sizes available

## SPECIFICATIONS

**DOOR:** 14 ga. steel, drywall bead

**TRIM:** 16 ga. steel, 1" wide perforated flange of 24 ga. galvanized material for mounting purposes, 2 1/2" deep

**FINISH:** Primed white baked enamel, paintable surface

**LATCHES:** Self-latching direct action latch, accepts both key and knurled knob

**HINGE:** Fully concealed, pivot rod type hinge. Allows opening to 140°

**INSULATION:** 2" thick mineral wool in between two pieces of steel

**CEILING INSTALLATION:** Largest size acceptable is up to and including 24" x 36"

# SUBMITTAL/TECHNICAL DATA SHEET

SKU: **BA-FR-DW**

## STANDARD DRYWALL FIRE-RATED ACCESS DOOR



## DIMENSIONS AND APPEARANCE

>> CLICK TO VIEW ADDITIONAL DETAILS AND PRICING <<

MODEL NO.	DOOR SIZE W X H	WALL OPENING	SLAM LATCH	SHIP. WEIGHT LBS.
FR DW 820	8 x 8	8 1/4 x 8 1/4	1	8
FR DW 820	10 x 10	10 1/4 x 10 1/4	1	10
FR DW 820	12 x 12	12 1/4 x 12 1/4	1	12
FR DW 820	12 x 18	12 1/4 x 18 1/4	1	15
FR DW 820	12 x 24	12 1/4 x 24 1/4	1	19
FR DW 820	14 x 14	14 1/4 x 14 1/4	1	14
FR DW 820	16 x 16	16 1/4 x 16 1/4	1	17
FR DW 820	18 x 18	18 1/4 x 18 1/4	1	21
FR DW 820	18 x 24	18 1/4 x 24 1/4	1	26
FR DW 820	20 x 30	20 1/4 x 30 1/4	1	24
FR DW 820	22 x 22	22 1/4 x 22 1/4	1	28
FR DW 820	22 x 24	22 1/4 x 24 1/4	1	29
FR DW 820	22 x 30	22 1/4 x 30 1/4	2	39
FR DW 820	22 x 36	22 1/4 x 36 1/4	2	47
FR DW 820	24 x 24	24 1/4 x 24 1/4	1	32
FR DW 820	24 x 30	24 1/4 x 30 1/4	2	43
FR DW 820	24 x 36	24 1/4 x 36 1/4	2	48
FR DW 820	24 x 48*	24 1/4 x 48 1/4	2	62
FR DW 820	30 x 30*	30 1/4 x 30 1/4	2	48
FR DW 820	32 x 32*	32 1/4 x 32 1/4	2	55
FR DW 820	36 x 36*	36 1/4 x 36 1/4	2	58
FR DW 820	36 x 48*	36 1/4 x 48 1/4	2	62
FR DW 820	48 x 48*	48 1/4 x 48 1/4	2	68

For detailed specifications see submittal sheet

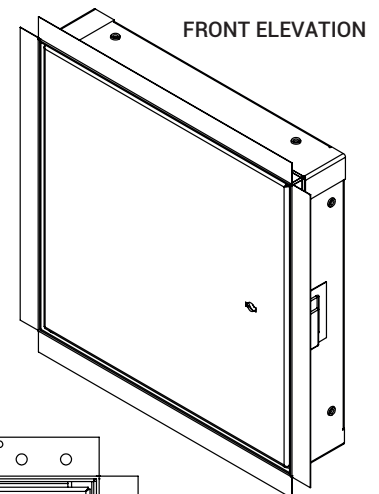

FRONT ELEVATION

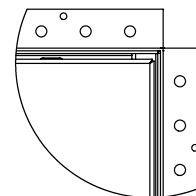

SECTION DETAIL

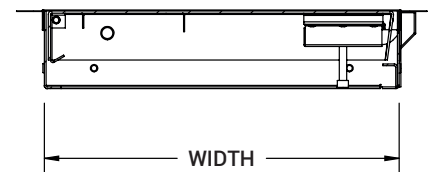



WIDTH

MANUFACTURED BY ACUDOR

For a complete list of options visit  
[www.BestAccessDoors.com](http://www.BestAccessDoors.com)

## PROJECT DATA

Custom Sizes Available - Fast!

Scan  or  Click



To view Pricing and  
Additional Product Info.

PROJECT NAME :	QTY	W	H	OPTIONS
ARCHITECT :				
DEALER :				
CONTRACTOR :				
LOCATION :	SPECIAL INSTRUCTIONS :			
DATE :				
TAGGING INSTRUCTIONS :	SUBMITTAL APPROVAL : (signature or stamp)			

TELEPHONE:  
1-800-483-0823  
FAX:  
1-888-828-6021



228 PARK AVE. S. #76520  
NEW YORK, NY, 10003



WEBSITE:  
[www.BestAccessDoors.com](http://www.BestAccessDoors.com)  
E-MAIL:  
[info@bestaccessdoors.com](mailto:info@bestaccessdoors.com)

## ■ FIRE RATING

### \*\* HOT SMOKE SEAL™ FIRE TESTED:

Listed to meet the requirements of standards UL10B, UL10C, UBC 7-2, Part 1 and BS476: 1987 for application to fire rated door assemblies. Tested for smoke controlled assemblies: Listed to meet the requirements of standards UL1784, NFPA 105, UBC 7-2, Part 2, and BS476:Part 31, Section 31.1:1983.

It also is a chemically inert, highly stable, expandable graphite strip, tested and proven in positive pressure conditions to withstand both hot smoke and hot gasses, resulting in the longer integrity of a door assembly. More economical to use than specially modified doors in "tested assembly only" classifications. Chemically inert, and therefore will not degrade from carbon dioxide and ozone like the many intumescent being offered by other manufacturers.

Hot Smoke Seal™ is not affected by moisture and will not break down like fiber or cellulose based products and does not require periodic after market field inspections.

### INSULATION:

is a rigid mineral wool (stone wool) insulation board for high temperature industrial applications subject to light mechanical loads.] - 2" thickness.

### NOTE:

For fire-rated ceiling access doors, on size 16" x 16" and larger, extra spring supplied with door must be attached from back of door pan to framing or floor above. In horizontal (ceiling) applications door has self-assisted closing.



UL Listed "B" label for  
1-1/2 hours (vertical).  
Warnock-Hersey listed for 3 hours (horizontal).

## ■ INSTALLATION: WALLS AND CEILINGS

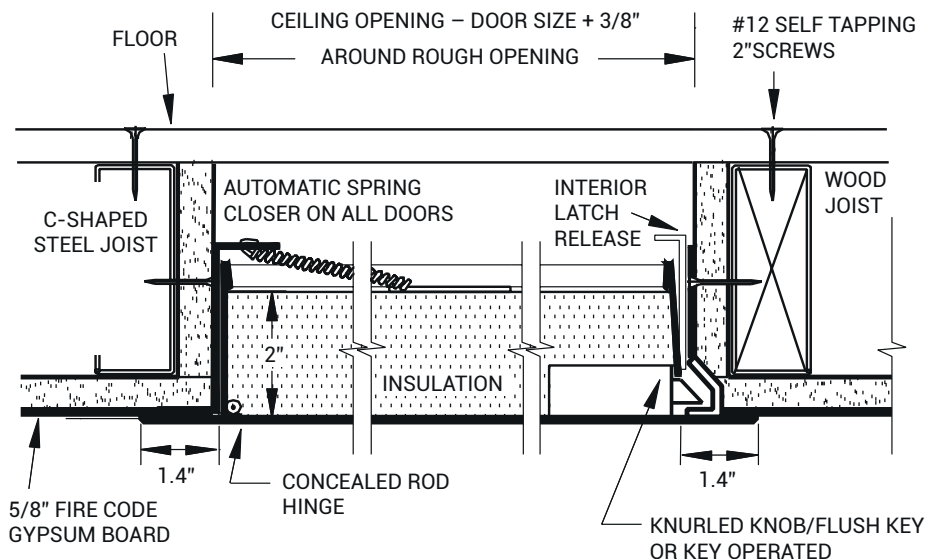

TELEPHONE:  
1-800-483-0823  
FAX:  
1-888-828-6021



228 PARK AVENUE  
S. #76520  
NEW YORK, NY, 10003



WEBSITE:  
[www.BestAccessDoors.com](http://www.BestAccessDoors.com)  
E-MAIL:  
[info@BestAccessDoors.com](mailto:info@BestAccessDoors.com)