



Quality Access Doors- **FAST!**

## APPLICATION

FV manual venting skylights allow you to appreciate the light and fresh air in places where it may be more reasonable not to use electric devices due to safety precautions.

## FEATURES

- Suitable for roof pitches between 18-85 degrees
- Low-emission and heat-reflecting double glazed glass
- Warm spacer increases condensation resistance
- Perimeter gasket underneath the frame
- Double seals between the frame and the sash
- Mosquito screen included
- operated with a crank or a control rod
- Range of internal and external accessories available
- Internal gasket system to collect and drain any possible condensation water to the outside

## SPECIFICATIONS

**FRAME MATERIAL:** Pine - Pressure Treated

**FRAME FINISH:** Two layers of clear acrylic lacquer

**GLAZING:** G31

- Low-E tempered over laminated
- Double-pane glazing unit with warm TGI spacer and Argon gas

**GASKETS SYSTEM:** Three rubber gaskets

**CONTROL:** Crank (included) or SZS control rod (not included)

**WARRANTY:** 10 years for skylight and glazing

# SUBMITTAL/TECHNICAL DATA SHEET

SKU: **BA-FV-L**

## DECK MOUNTED MANUAL VENTING SKYLIGHT FV

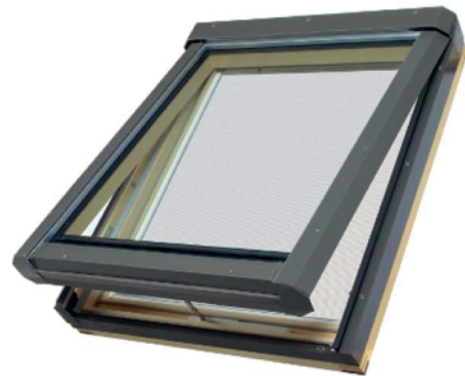

## DIMENSIONS AND APPEARANCE

>> CLICK TO VIEW ADDITIONAL DETAILS AND PRICING <<

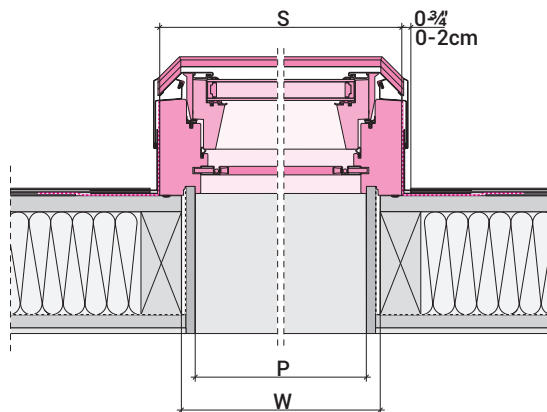

For more details see the second page

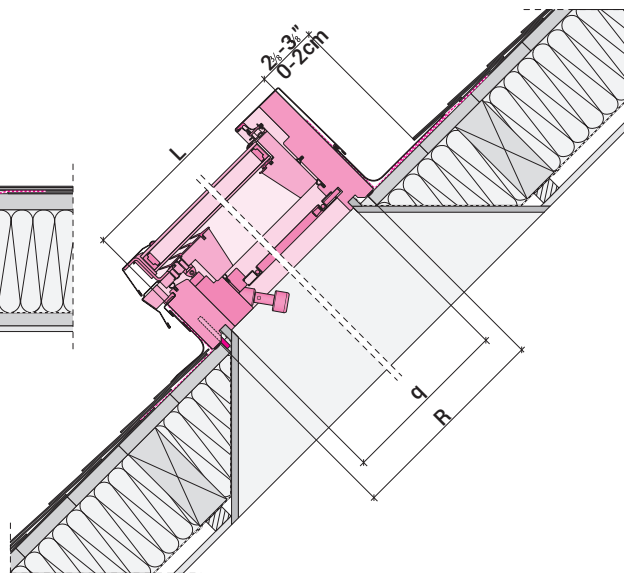



### ADDITIONAL PRODUCTS TO BE USED:

Ice and Water Guard	- Fakro Euroband or similar self-adhesive underlayment	Flashings	- EH - for roof tiles, corrugated metal and standing seam - EL - for shingles and shakes
Included mounting accessories	- Bit PZ2 50mm length - Bit PZ3 50 mm length - Nail 2,5x25 - Base pin - Countersunk head screws	External accessories	- SMZ solar awning blind
		Internal accessories	- SRF blackout blind, SRP light reducing blind - Hex Ball adapter for control rod - SZS control rod

## PROJECT DATA

**Custom Sizes Available - Fast!**

PROJECT NAME :	QTY	W	H	OPTIONS
ARCHITECT :				
DEALER :				
CONTRACTOR :				
LOCATION :	SPECIAL INSTRUCTIONS :			
DATE :	SUBMITTAL APPROVAL : (signature or stamp)			
TAGGING INSTRUCTIONS :				

Scan  or  Click



To view Pricing and Additional Product Info.



TELEPHONE:  
1-800-483-0823  
FAX:  
1-888-828-6021



228 PARK AVE. S. #76520  
NEW YORK, NY, 10003



WEBSITE:  
www.BestAccessDoors.com  
E-MAIL:  
info@bestaccessdoors.com

**BA-FV-L**

# DECK MOUNTED MANUAL VENTING SKYLIGHT FV

## DIMENSIONS:

Size		301	304	306	308	312	504	506	508	801	806
Rough opening (WxR)	in.	22½ x 26½	22½ x 37½	22½ x 45½	22½ x 54	22½ x 70	30½ x 37½	30½ x 45½	30½ x 54	46½ x 26½	46½ x 45½
Outside frame (SxR)	in.	24½ x 27½	24½ x 38½	24½ x 46¾	24½ x 55	24½ x 70¾	32½ x 38½	32½ x 46¾	32½ x 55	48½ x 27½	48½ x 46¾
Daylight area (Glass)	sq. ft. m2	2.58 0.24	3.98 0.37	4.95 0.46	6.03 0.56	7.97 0.74	5.70 0.53	7.10 0.66	8.61 0.80	5.92 0.55	11.41 1.06
Finished opening (PxQ)	in.	20⅞ x 24⅞	20⅞ x 35⅞	20⅞ x 43¾	20⅞ x 52¾	20⅞ x 68⅞	28⅞ x 35⅞	28⅞ x 43¾	28⅞ x 52¾	44⅞ x 24⅞	44⅞ x 43¾

## TECHNICAL PARAMETERS:

Technical parameters	Glazing unit type	
	Unit	G31
U-factor	[BTU/h ft²F]	0.41
Ug for glazing unit	[BTU/h ft²F]	0.19
Solar Heat Gain Coefficient	-	0.19
Air Leakage	[cfm/ft²] @ 1.57 psf, tested size 24x70	0.06
Visible Transmittance	-	0.36
UV protection	-	99.8
Condensation Resistance	-	53
Water Penetration Resistance Test Pressure	[Pa]	730
Wind load resistance	Class C1/B1	
Impact resistance	Class 3 – 450 mm	

