

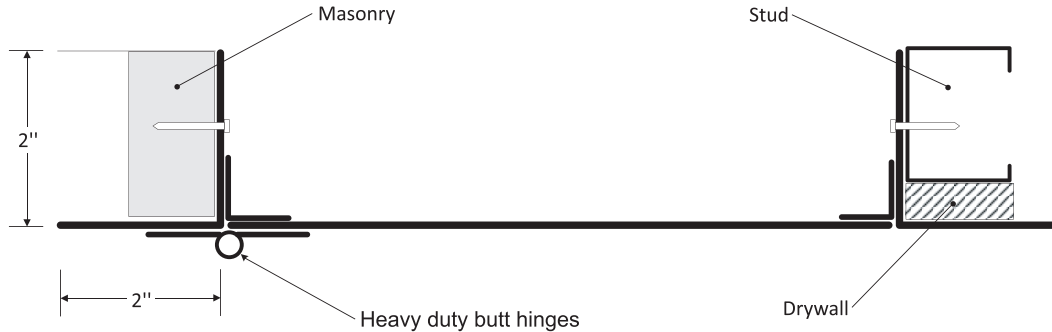

HIGH SECURITY ACCESS DOOR
FOR ALL SURFACE TYPES

BA-PHS

INSTALLATION



DIMENSIONS AND APPEARANCE

LEED ready: This product contributes to LEED® credits.

DOOR SIZE - W x H INCHES (MM)	WEIGHT	
	LBS	KG
12 x 12 (304 x 304)	22	10
16 x 16 (406 x 406)	30	13.6
18 x 18 (457 x 457)	34	15.4
24 x 24 (609 x 609)	49	22.2
24 x 30 (609 x 762)	57	25.9
24 x 36 (609 x 914)	65	29.5
36 x 36 (914 x 914)	86	39
Rough wall opening is door size + 1/4" or + 6mm		

**Your odd sizes:
Made in 5 days**

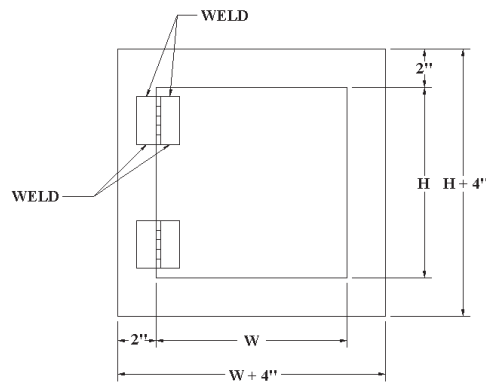

Lock and cylinder optional

DESCRIPTION AND MATERIAL SPECIFICATION

- Material:** 10 gauge cold rolled steel plate
2" x 2" x 3/16" thick angle frame
- Hinge:** 3" x 3" (13 Ga Steel) heavy duty butt hinges
13 gauge cold rolled steel
- Lock / latch:** as per customer's request
- Finish:** high quality white powder coat primer
- Packaging:** individually wrapped, 1 per box

POPULAR OPTIONS For complete list of options go to: www.BestAccessDoors.com
Lock / latch: mortise preparation (cylinder optional),
 mortise deadbolt lock,
 mortise preparation for detention lock



Click here to view the Products

PROJECT DATA

PROJECT NAME:	QTY	W	H	OPTIONS
ARCHITECT:				
DEALER:				
CONTRACTOR:				
LOCATION:	SPECIAL INSTRUCTIONS:			
DATE:				
TAGGING INSTRUCTIONS:	SUBMITTAL APPROVAL: (signature or stamp)			

ADDRESS: 427 N Tatnail St, #76520 Wilmington, DE 19802-2230

Tel.: 1-800-483-0823
Fax: 1-888-828-6021

www.bestaccessdoors.com
sales@bestaccessdoors.com