



Quality Access Doors- **FAST!**

APPLICATION

The BA-WTD Walk Through Access Door is an insulated walk through door. It provides easy access to interior duct work and air handling equipment. It is constructed with galvanized steel to ensure durability. It comes complete with neoprene gasketing, insulation, full length piano hinge and L-Handle locking latch that is operable from both sides.

OPTIONAL FEATURES

- Stainless steel #304 and #316 (#4 satin finish)
- Extra latches
- Key cylinder lock with key (code 151)
- Custom sizes available
- (At extra cost)

SPECIFICATIONS

DOOR: 22 ga. satin coat

TRIM: 16 ga. satin coat

RETURN FRAME: 16 ga. satin coat, 1 3/4" deep

HINGE: Full-length piano hinge

LATCH: L-Handle operable from both sides
Doors higher than 48" come with 3 handles

INSULATION: 1" thick AMVIC SilverBoard Ridge Foam Insulation

GASKET: Neoprene gasketing on all 4 sides of door

FINISH: Powder coat aluminum finish

SKU: **BA-WTD**

WALK THROUGH ACCESS DOOR



DIMENSIONS AND APPEARANCE

>> [CLICK TO VIEW ADDITIONAL DETAILS AND PRICING](#) <<

MODEL NO.	A x B DOOR SIZE	HINGES	LATCH	SHIPPING WEIGHT (LBS)
BA-WTD 24 x 36	24" x 36"	1	2	32
BA-WTD 24 x 48	24" x 48"	1	2	42
BA-WTD 24 x 60	24" x 60"	1	3	52
BA-WTD 24 x 72	24" x 72"	1	3	62
BA-WTD 30 x 36	30" x 36"	1	2	39
BA-WTD 30 x 48	30" x 48"	1	3	52
BA-WTD 30 x 60	30" x 60"	1	3	65
BA-WTD 30 x 72	30" x 72"	1	3	78

Rough wall opening = door size + 1/4"

MANUFACTURED BY ACUDOR

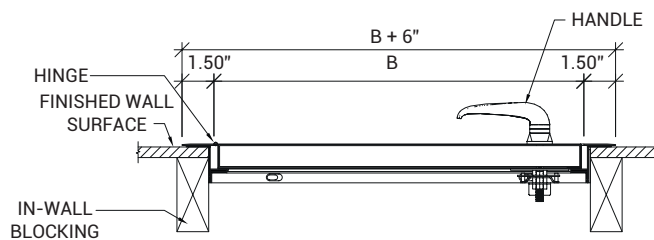

SECTION DETAIL

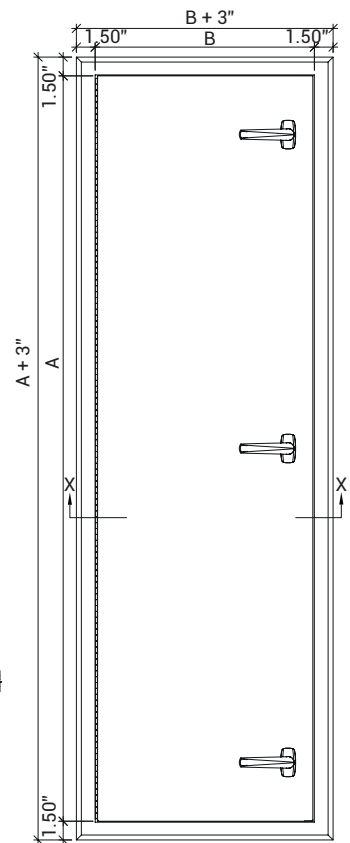



ELEVATION

For a complete list of options visit
www.BestAccessDoors.com

PROJECT DATA

Custom Sizes Available - Fast!

PROJECT NAME :	QTY	W	H	OPTIONS
ARCHITECT :				
DEALER :				
CONTRACTOR :				
LOCATION :	SPECIAL INSTRUCTIONS :			
DATE :				
TAGGING INSTRUCTIONS :	SUBMITTAL APPROVAL : (signature or stamp)			

Scan  or  Click



To view Pricing and
Additional Product Info.



TELEPHONE:
1-800-483-0823
FAX:
1-888-828-6021



228 PARK AVE. S. #76520
NEW YORK, NY, 10003



WEBSITE:
www.BestAccessDoors.com
E-MAIL:
info@bestaccessdoors.com